

FELLOW®

Carter™ Move Mug + Slide-Lock Lid

SAFETY AND USE GUIDE

Please read this guide completely before using. Improper handling may result in product damage or an accident. Please keep this guide for future reference.

Please do not use with the following:



Dishwasher



Oven



Microwave

IMPORTANT SAFETY NOTES

Check your Carter to ensure that all pieces of product are accounted for and installed correctly. Do not use if parts are missing.

Do not use if you see signs of cracking, chipping, and or any other abnormality.

Keep Carters holding hot beverages away from children and pets.

USE INSTRUCTIONS

Preparation Before Use

Wash thoroughly with dish soap and a soft sponge.

Use Guide

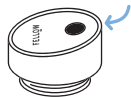

Place your thumb on the circle indent located on the slide-lock disc. Push your thumb forward to open the slide-lock disc to reveal the sip hole.

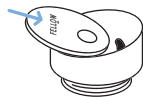

To close the slide-lock disc, use a finger to push the back edge into place until you hear a click. The click indicates a secure, leak-proof closure.

Please pay attention when setting down. The Carter body is sturdy stainless steel but will dent if dropped on hard surfaces.

Carter is not microwave safe.

Do not use any metal stirring utensils in Carter. This will scratch the ceramic non-stick coating.

Do not let children use.

CLEANING AND MAINTENANCE

Please hand wash Carter. Dishwashing the product—even on the top rack—may result in discoloration of the coating.

For hand washing, use only liquid dish soap. Do not use chlorine, bleach, or other chemicals to clean. Let air or towel dry thoroughly.

Using a coarse sponge, brush, or other rough surface will scratch the outer and interior surfaces of Carter. Use only a soft sponge.

While not in use, store Carter with the lid off to prevent unwanted smells.

Once a week, disassemble the slide-lock lid completely to hand wash each part thoroughly.

HOW TO DISASSEMBLE LID



① Unscrew the **lid** from the Carter body. Set the Carter body aside.



② Find the **knob** on the underside of the lid. While pulling it down, push the **slide-lock disc** on the top surface towards the sip hole to detach it from the rest of the lid.



③ Looking at the top, use your fingers or a coin to push down and turn the **piston** a quarter-turn counterclockwise to release remaining parts. Remove **spring** and **seal** and set aside.



④ Hand wash each piece individually with warm water and soap. Dry with towel or air dry before assembly.

HOW TO ASSEMBLE LID

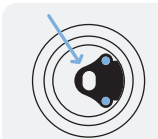

① On the underside of the lid, place the **seal** onto the two posts inside the main body of the lid by aligning the corresponding two holes.



② Flip the lid over while holding the **seal** in place. Place the **spring** in the center hold of the lid.



③ With the **sip hole** at six o'clock, insert the **piston** into the spring oriented parallel to the lid tracks. Push the **piston** down until it stops, then turn a quarter-turn clockwise using your fingers or a coin. The **piston** and the **seal** should now be secured.

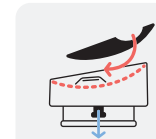

④ Find the **knob** on the underside of the lid. While pulling it down, slide the **slide-lock disc** onto the tracks by pushing the indent towards the Fellow logo. Test assembly by opening and closing the **slide-lock disc**.



⑤ Screw **lid** back onto the Carter Move Mug body and enjoy your next drink!

Watch video to learn how to disassemble and assemble the slide-lock lid:



For more help head to: help.fellowproducts.com

Fellow Industries Inc.
San Francisco, CA 94110
U.S. and International Patents Pending
Fellowproducts.com